

Ø .530  
[13,46]

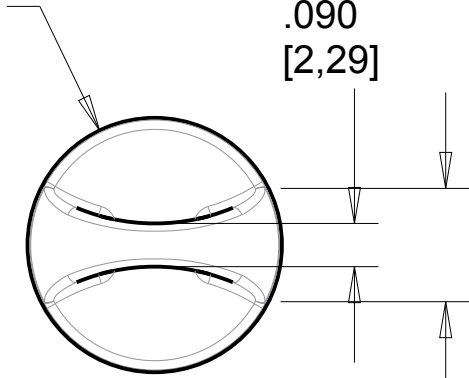

3/8"



.375  
[9,53]

1/4"



.2500  
[6,35]

3/16"



.1875  
[4,763]

SHAFT LENGTH

.236  
[5,99]

.215  
[5,46]

.048  
[1,22]

.105  
[2,67]

.180  
[4,57]

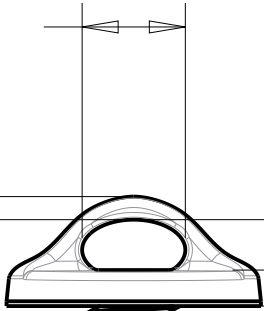

.010  
[0,25]

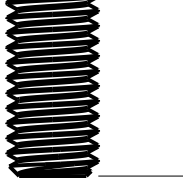

.075  
[1,91]

.3750  
[9,525]

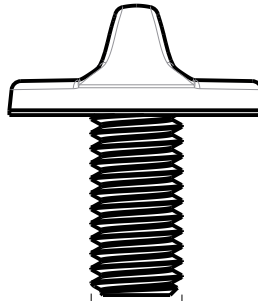

Ø .1891  
[4,803]

MAJOR

10-32 THREAD



REF VIEW

DIM ARE IN INCHES DIM IN [ ] ARE IN MM UNITS IN [ ] ARE ISO METRIC EXCEPT AS NOTED	DWN CHK REL	DATE Sep-25-14	DWG. NO. LOOP-SCREW MPLH SERIES
	TOLERANCES: X.XX±     0.03 X.XXX±    0.010 ANGLES±   1.0		TITLE: LOOP SCREW FOR USE WITH LARGE-HEAD SLOTTED POSTS
MAT'L CELCON, CLEAR	TREAT	POPCO INC.	
NOTICE - POPCO INC. CLAIMS PROPRIETARY RIGHTS IN THE INFORMATION DISCLOSED ON THIS DRAWING. IT IS ISSUED IN CONFIDENCE FOR ENGINEERING INFORMATION ONLY AND MAY NOT BE REPRODUCED OR USED TO MANUFACTURE ANYTHING SHOWN HEREON WITHOUT DIRECT WRITTEN PERMISSION FROM POPCO INC. TO THE USER.			ECO#      -      SCALE:    2.500 ESTIMATED WEIGHT:    0.0 LB.      DWG NO:

REV	DESCRIPTION	DATE	ECO#	CHG NOTICE